

Rockmart Public Works Facility

Project No. 2025-PW1

ADDENDUM No. 2

May 1, 2025



Applying to all Bidders.

This addendum is issued for the purpose of clarifying the intent of the Contract Documents for making necessary corrections, deletions, and/or additions to the Documents on all items of discrepancy raised up to the issuance of this addendum.

Each Bidder is hereby instructed and authorized to incorporate into their proposal the instructions contained in this addendum.

TO ALL BIDDERS

PROJECT MANUAL REVISION – 1.2(F) ALLOWANCE SCHEDULE

Additions

4. Material Allowance for Floor Tile: \$8.00/sf. Contractor shall include in base bid, procurement, delivery, storage, tools and labor, and grouting.

GENERAL – REQUEST FOR INFORMATION / CLARIFICATIONS

All responses are **bolded** for clarity.

Who is responsible for the site work on this project? **Currently, the City intends to complete the grading and site prep work in house, under the direction of the city engineer, prior to commencement of the construction project. The building pad will be the responsibility of the successful bidder, this includes any final excavation necessary to form the pad.**

What is currently at the location of this project? **Practice softball field.**

Is the owner or the GC responsible for the sitework on this project? **The building pad will be prepped and ready for foundation work by the owner. The General Contractor shall be responsible for carrying and connecting all utilities to within 6' of the building pad, as well as any and all pads associated with HVAC units, generators, landing pads at exit/entry doors, and sidewalks along the perimeter of the building. Additionally, the General Contractor shall be responsible for a small parking area shown on the western side at the front entrance and is to be included in the scope of work with the building. Please see the attached highlighted drawing that are incorporated in this addendum as "Exhibit A".**

Is the GC to install the stormwater system and pond? **Owner**

Is the GC to provide the fence around the property? **No.**

Is GC to provide the potable water line? If so please clarify" **Please see clarification of scope of work in Addendum 1.**

What is the thickness of the concrete for the dumpster pad area? Is there any type of enclosure around the dumpster pad? Please provide more details and information. **This item is not within the current scope of work. Please see clarification of scope of work in Addendum 1.**

What are the sand and gravel bins to be constructed out of? Is there a concrete slab, if so what is the thickness? What are the gravel bin walls constructed out of? Please provide more details and information. **This item is not within the current scope of work. Please see clarification of scope of work in Addendum 1.**

Who is responsible for providing the light poles with cameras? If GC is responsible please provide camera information and IT equipment needed to operate the cameras. **The General Contractor shall be responsible for only those poles that may be necessitated by the installation of camera and security system that is listed in 1.2(F) Allowance Schedule.**

Site plan notes 2 power sliding gates, however the electrical schedule does not show power to these gates. Are these gates to be power operated? Please clarify. **This item is not within the current scope of work. Please see clarification of scope of work in Addendum 1.**

Site Plan notes for the paving in the area to be gravel. Is this 57 stone or GAB? Please clarify. **This item is not within the current scope of work. Please see clarification of scope of work in Addendum 1.**

What is the thickness of the gravel paving? **This item is not within the current scope of work. Please see clarification of scope of work in Addendum 1.**

Please provide a plumbing fixture schedule. There are not manufactures or model numbers noted for the plumbing fixtures that are noted on the plumbing drawings.

Please provide specifications for the PreEngineered Metal Building. None are noted on the drawings. **The pre-engineered metal building drawings must be submitted by the contractor after the contract award is made. The building must meet the standards of all relevant international codes, be certified by a licensed architect, and comply with all specifications included in the bid documents. Fabricator and erector must be certified by MBMA or equivalent.**

In order to price the prep of the building pad, we will need a grading plan. Are you planning to issue a grading plan or civil drawing set? **The building pad will be prepped and ready for foundation work by the owner.**

The 12" Pad and Diesel Generator is provided by the contractor, not the sub-contractor, correct? **The successful bidder will be responsible for the 12" Pad and Diesel Generator.**

Are the panels existing or are they new? If they are new, will the owner be supplying them? **The successful bidder will be responsible for all electrical panels. All electrical components must be new.**

Will the owner be supplying the disconnects? **The successful bidder will be responsible for all disconnects.**

We are interested in bidding on the insulation, drywall, painting, and any ACT if applicable for the Rockmart Public Works Facility project. Who is the best person to follow up with to get a set of plans? **Bidding Documents may be obtained electronically from the City of Rockmart's website: <http://www.rockmart-ga.gov/>. Printed copies of the Bidding Documents for a Stipulated Price contract may be obtained from Greene's Blueprinting, LLC, located at 169 South Church Street, Canton, Georgia, 30114, and contact information being (770) 479 – 3773 and greeneprinting@greeneprinting.com. Bidding Documents can only be obtained as a complete set. Bidding Documents can only be obtained by General Contract and Subcontract Bidders.**

Are gravel/sand bins, dumpster pads and the concrete approach pads to be included within the base bid? **This item is not within the current scope of work. Please see clarification of scope of work in Addendum 1.**

Are light poles and cameras in parking lot to be included within the base bid? **This item is not within the current scope of work. Please see clarification of scope of work in Addendum 1.**

How much gravel in the parking lot is the G.C. responsible for, if any? **This item is not within the current scope of work. Please see clarification of scope of work in Addendum 1.**

Are the fencing and sliding gates in the scope of work for the general contractor? **This item is not within the current scope of work. Please see clarification of scope of work in Addendum 1.**

What landscaping is to be included within the scope of work? **This item is not within the current scope of work. Please see clarification of scope of work in Addendum 1.**

Is the general contractor responsible for striping the asphalt parking spaces? **Yes**

Are the three light poles shown on the site plan part of the electrical scope? **The General Contractor shall be responsible for only those poles that may be necessitated by the installation of camera and security system that is listed in 1.2(F) Allowance Schedule.**

Is the power pole with transformer in the GC's scope, or will the city do that alongside the site work? **The City of Rockmart will work with Georgia Power to bring power to the site, including setting necessary poles and other grid improvements. However, the GM will be responsible for connecting power to the building.**

Please provide an allowance or a manufacturer, collection, and color for each flooring product. **Basis of Design for LVT: Armstrong, Solid Vinyl Tile/LVT, Parallel 20 USA, 6" x 48", Running Bond Pattern, Standard Colors (please see Exhibit B). Material Allowance for Floor Tile: \$8.00/sf. Contractor shall include in base bid, procurement, delivery, storage, tools and labor, and grouting.**

Please provide specifications for the fire sprinkler system. **Final design of fire suppression system must be submitted by the contractor after the contract award is made. The system must meet the standards of all relevant international codes and comply with all specifications included in the bid documents.**

Will the storage building require a fire sprinkler system? **No.**

Will seismic bracing be required? **The building must meet the standards of all relevant international codes and specifications included in the bid documents. Additional seismic bracing will not be required beyond these specifications.**

Can you please provide clarification regarding the LVT and Ceramic Tile specifications?
Basis of Design for LVT: Armstrong, Solid Vinyl Tile/LVT, Parallel 20 USA, 6" x 48", Running Bond Pattern, Standard Colors (please see Exhibit B). Material Allowance for Floor Tile: \$8.00/sf. Contractor shall include in base bid, procurement, delivery, storage, tools and labor, and grouting.

END OF DOCUMENT

Rockmart Public Works Facility

Project No. 2025-PW1

ADDENDUM No. 2

Exhibit A

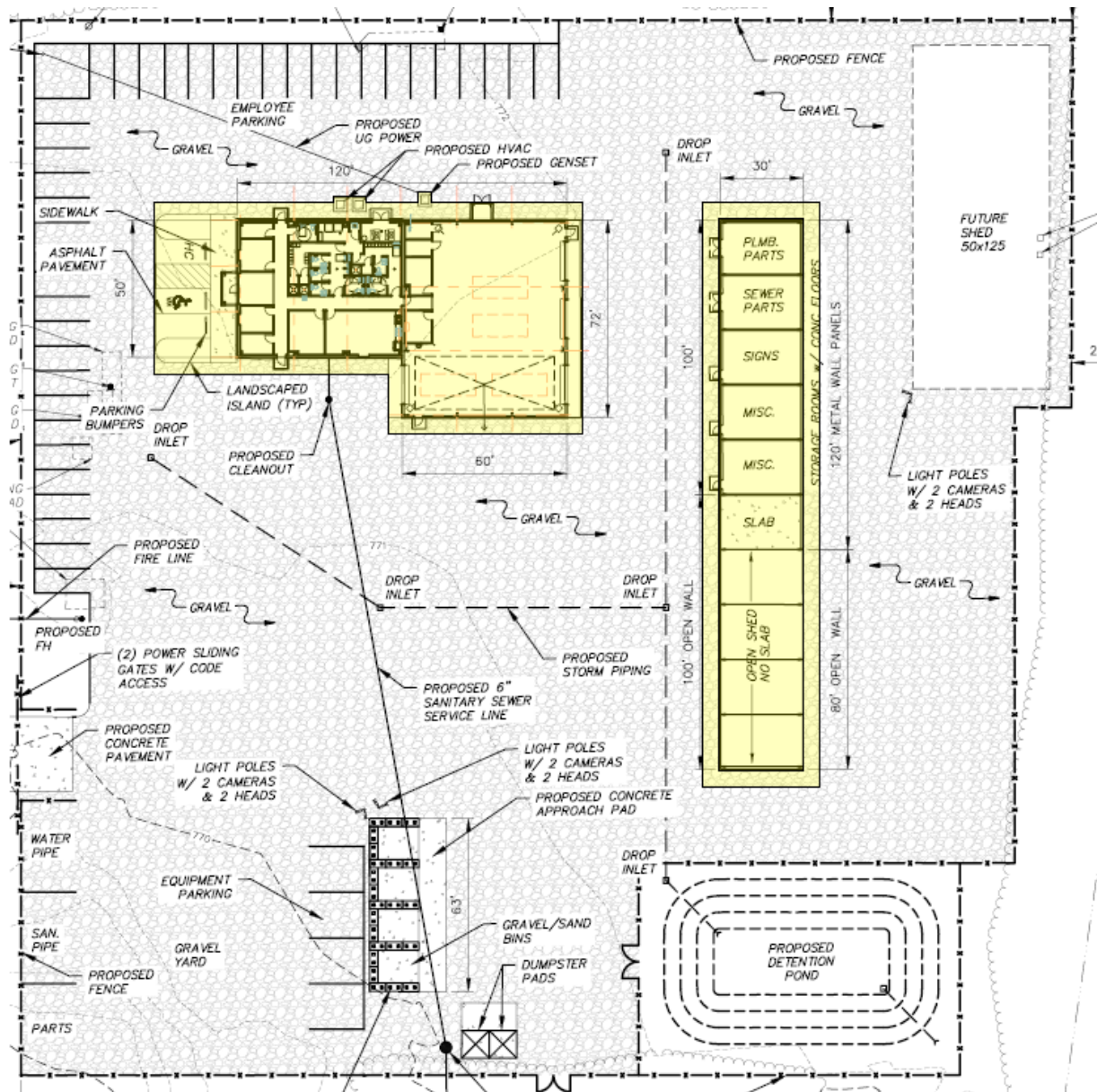

ADDENDUM No. 2

Exhibit B



ArmstrongFlooring®

LUXURY FLOORING

Parallel® USA 20 | Parallel® USA 12

Product Information

Construction - Solid Vinyl Tile (Luxury Vinyl Tile / LVT)

International Specifications - ASTM F1700, Class III, Type B embossed surface

Overall Thickness - Parallel USA 20: 0.100 in. (2.5 mm); Parallel USA 12: 0.080 in. (2.0 mm)

Wear Layer Thickness - Parallel USA 20: 0.020 in. (0.5 mm); Parallel USA 12: 0.012 in. (0.3 mm)

Factory Finish - Urethane Plus

Installation - Adhesives: S-995, S-319 Roll Strong™, S-1000

Maintenance Options - No Polish - No Buff, Polish Optional

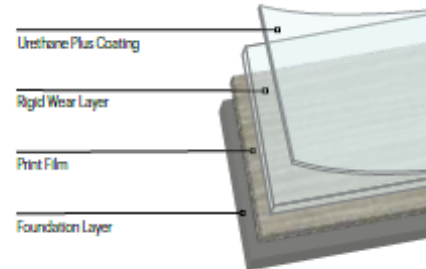

Packaging

Sizes	Pieces per Carton/Coverage	Shipping Weight per Carton
Parallel® USA 20 6 in. x 48 in. (152.4 mm x 1219.2 mm) 18 in. x 18 in. (457.2 mm x 457.2 mm)	18 - (36 sq. ft.) 3.34 m ² 16 - (36 sq. ft.) 3.34 m ²	39 lbs./carton (17.69 kg) 39 lbs./carton (17.69 kg)
Parallel® USA 12 6 in. x 48 in. (152.4 mm x 1219.2 mm) 18 in. x 18 in. (457.2 mm x 457.2 mm)	18 - (36 sq. ft.) 3.34 m ² 16 - (36 sq. ft.) 3.34 m ²	29 lbs./carton (13.15 kg) 29 lbs./carton (13.15 kg)

Testing

ASTM F1700			
Performance	Test Method	Requirement	Performance vs. Requirement
Thickness	ASTM F386	Nominal ±0.005 in.	Meets
Wear Layer Thickness	ASTM F410	0.020 in. (0.5 mm) minimum for Commercial Use	Parallel USA 20 - Meets
Size	ASTM F2421/F2055	± 0.015 in. per linear foot	Meets
Squareness	ASTM F2421/F2055	0.010 in. maximum	Meets
Residual Indentation	ASTM F1914	Average less than 8%	Meets
Dimensional Stability	Internal	≤ 0.018 in. per linear ft. MD ≤ 0.012 in. per lin. ft. AMD	Meets
Chemical Resistance	ASTM F925	No more than slight change in surface dulling, attack or staining	Meets
Resistance to Heat	ASTM F1514	ΔE < 8	Meets
Resistance to Light	ASTM F1515	ΔE < 8	Meets
Static Load Resistance @ 250	ASTM F970	< 0.005 in.	Meets
Additional Testing			
Static Load Resistance	ASTM F970*	≤ 0.005 in.	2000 psi
Fire Test Data - Flame Spread	ASTM E648	0.45 W/cm ² or more Class 1	Meets
Fire Test Data - Smoke Evolution	ASTM E 84	450 or less	Meets
Fire Test Data - Canada	CAN/ULC S-102.2	Use dependent	Parallel 20: Flame Spread - 5; Smoke Developed - 75 Parallel 12: Flame Spread - 0; Smoke Developed - 50
ADA Standards for Accessible Design	Chapter 3, Section 302.1	Floor surfaces shall be stable, firm and slip resistant	Meets
Static Coefficient of Friction**	ASTM D2047/UL 410	≥ 0.5	Meets

ArmstrongFlooring

LUXURY FLOORING

Parallel® USA 20 | Parallel® USA 12

Sustainability

WELL v1 Feature	Parallel USA	Contribution
Air		
Feature 04 - VOC Reduction	✓	Tested and third party certified by FloorScore® as complying with CDPH v1.2
Feature 11 - Fundamental Material Safety	✓	Product is free of asbestos and added lead (Part 1)
Feature 25 - Toxic Material Reduction	✓	Free of flame retardants (Part 2) and phthalates (Part 3)
Mind		
Feature 97 - Material Transparency	✓	Readily available Health Product Declaration® (HPD) to 1000 ppm
Feature 88 (Part 2) Biophilia I - Qualitative	✓	Products available that incorporate nature patterns
Feature 99 - Beauty and Design II	✓	Patterns and colors to aid in wayfinding and spatial familiarity (Part 3)

WELL v2 Feature	Parallel USA	Contribution
Materials		
Feature X01.1 Material Restrictions	✓	Product is free of asbestos
Feature X05.1 Enhanced Material Restrictions	✓	Free of flame retardants (Part 2) and phthalates (Part 3)
Feature X06.1 VOC Restrictions	✓	Adhesives associated with product are tested and third party certified by FloorScore as complying with CDPH v1.2
Feature X06.2 VOC Restrictions	✓	Flooring is tested and third party certified by FloorScore as complying with CDPH v1.2
Feature X07.1 Material Transparency	✓	Readily available Health Product Declaration (HPD) to 1000 ppm
Mind		
Feature M02.1 Nature and Place	✓	Products available that incorporate nature patterns
Community		
Feature C13 (Part 2) Accessibility and Universal Design	✓	Patterns and colors to aid in wayfinding and spatial familiarity

LEED® v4.1	Parallel USA
BPDD - EPD	Third Party certified Product Specific
BPDD - Material Ingredient	HPD
BPDD - Sourcing	29% pre-consumer recycled content
Location of Manufacturer	EPR - On&On Recycling Program
Low Emitting Flooring	USA
Low Emitting Adhesives	Tested and third party certified by FloorScore as complying with CDPH v1.2
SCAQMD #116B Compliant	Tested and compliant to CDPH v1.2, Methylene Chloride and Perchloroethylene not intentionally added, FloorScore Certified
Adhesives meet <50 g/L requirement	S-995 - 0 g/L S-319 Roll Strong - 0 g/L S-1000 - 0.1 g/L

Carbon Footprint	Parallel USA
Global Warming Potential, including Biogenic Carbon Raw Materials (A1) through Production (A3)	0.64 Kg CO ₂ eq. / square foot (6.88 Kg CO ₂ eq. / square meter)

Limited Warranty

Parallel USA 20

15-year Commercial; 30-year Residential Warranty when installed in strict accordance with the detailed instructions.

Parallel USA 12

7-year Commercial; 15-year Residential Warranty when installed in strict accordance with the detailed instructions.